



CITO SECURE PRESSER

Presser with safety strap, especially for fast running machines developed – keeps the sheet flat during the stripping process

CITO SECURE PRESSER is a fast reacting spring element, secured with a safety sling, for mounting between the presser plate and the upper stripping die. By using a presser plate, the sheets are pressed uniformly flat during the stripping process. This ensures trouble-free production with high performance for machine speeds of over 7,000 sheets per hour.

The advantages at a glance:

- Consistent pressure across the entire surface of the lower stripping tool
- Minimizing wear on machine parts (e. g. frames, transfer) due to improved pressure distribution on the lower stripping die
- Safe use due to safety sling
- High machine speeds and long runs



Further information
on CITO SECURE PRESSER:
www.cito.de/secure-presser

Description	Colour	Unit	Order no.
CITO SECURE PRESSER with integrated safety strap, incl. screws	Yellow	50 pc.	BLA02004

Function

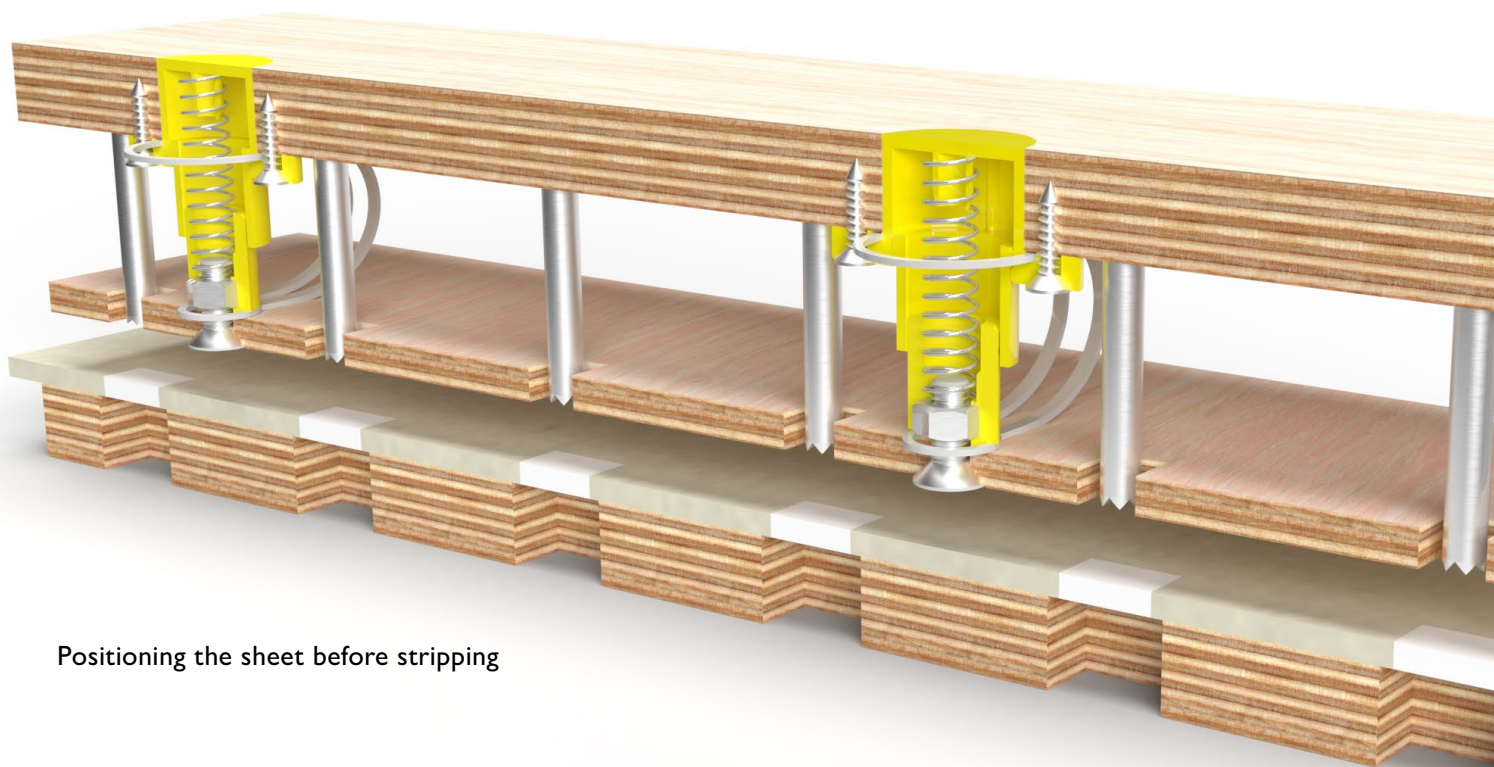

Positioning the sheet before stripping

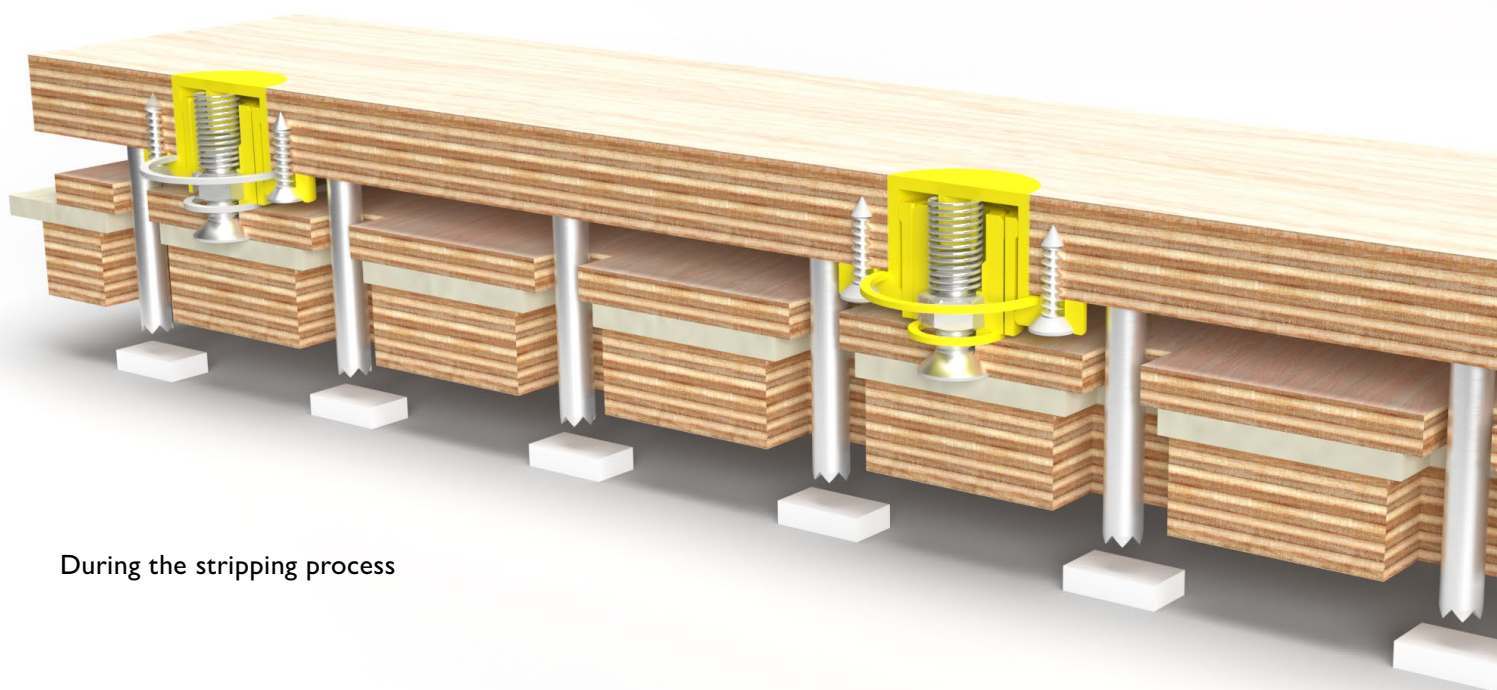

During the stripping process

UPPER STRIPPING PLATE

Laser cut for the upper stripping plate for exact positioning of the screws.

PRESSER PLATE

Recommended, optimised laser cut for the presser plate, e.g. wood panel 6 mm, suitable for possible replacement.

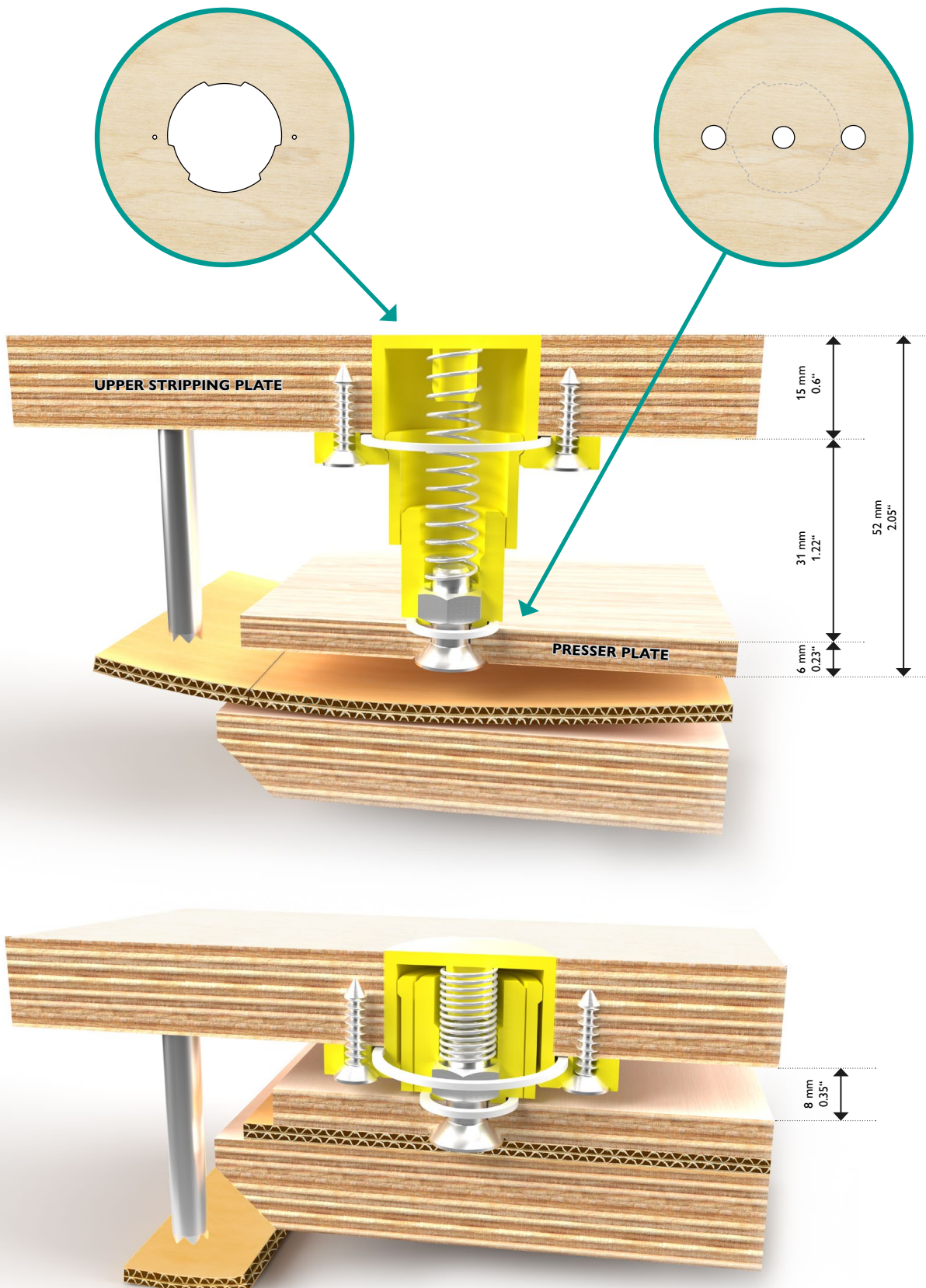

Use



Recommended laser cut in the upper stripping plate and CITO SECURE PRESSER with integrated safety strap.



Use the screws supplied to fix the CITO SECURE PRESSER in the upper stripping plate.



Latch the safety strap at the top of the narrow part of the CITO SECURE PRESSER into position (click) and put on the presser plate*.

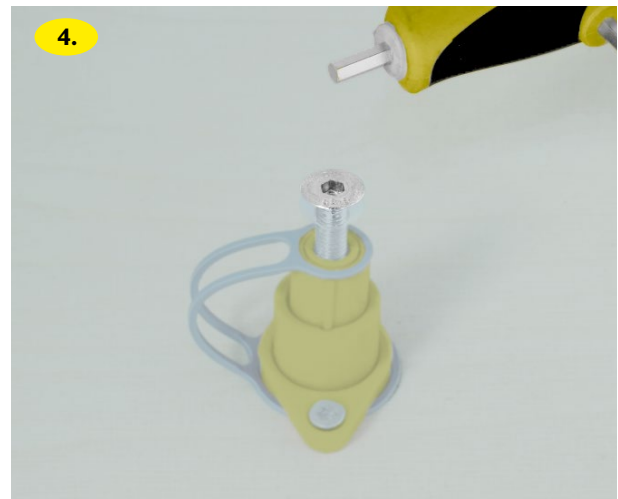

Screw the presser plate onto the CITO SECURE PRESSER, finished. We recommend to additionally secure the screw.

* The presser plate here is made of transparent plastic. Wood is a good alternative.

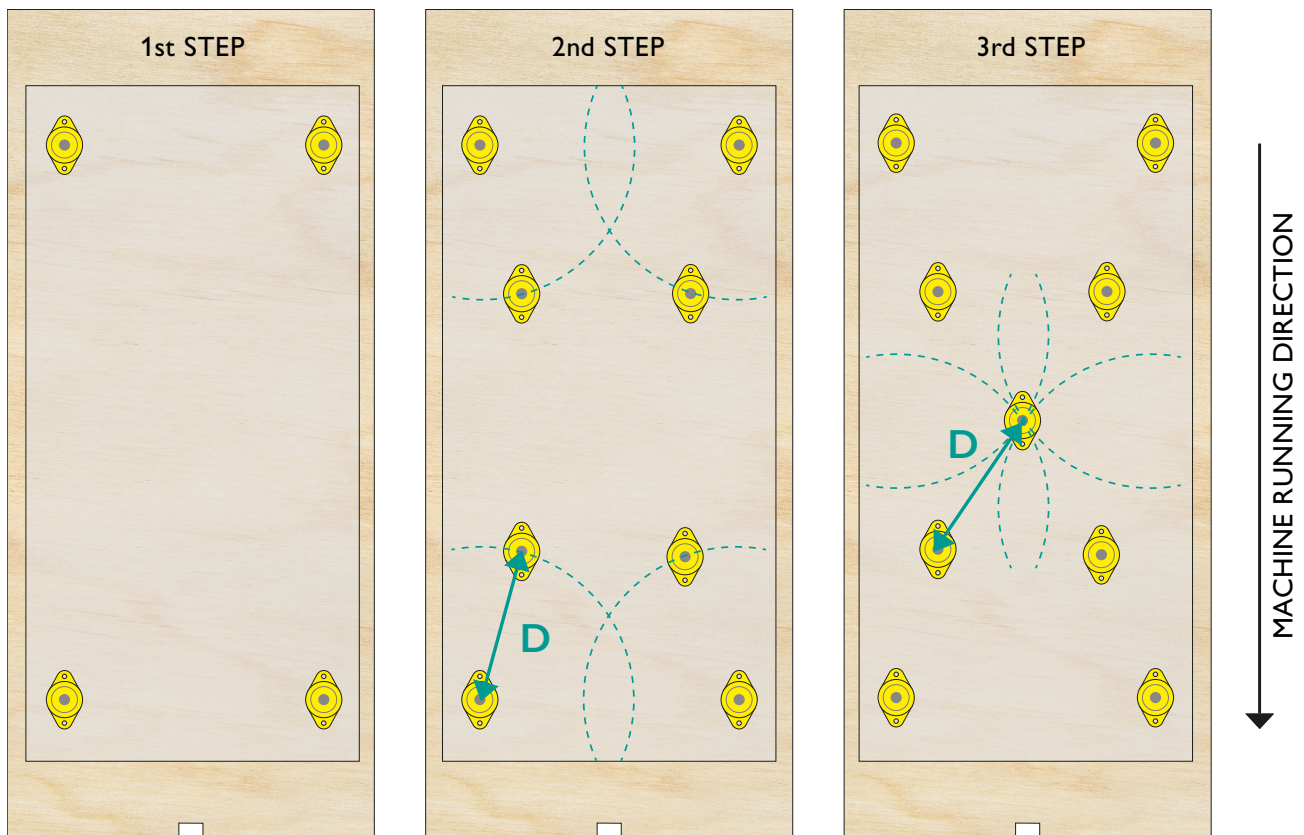

1. Where possible, place one CITO SECURE PRESSER each in all 4 corners.
2. Set further CITO SECURE PRESSER at distance **D = 250 mm (10")**.
3. Set further CITO SECURE PRESSER within radius **D = 250 mm (10")**.



Presser plates should be divided into useful segments horizontally across the machine running direction.

CITO SECURE PRESSERS can only be used in places with sufficient space for the waste.

The values given here refer to cardboard sheets and corrugated board sheets.

If using cardboard material with secondary fibres (recycled) up to 0.8 mm (0.03") thick, the distance between the CITO SECURE PRESSERS can be approx. 20 % larger.

Additional laser cutouts in the presser plate are useful, which can only be used if necessary.

The overall balance of the presser plate is important (no one-sided tilting).

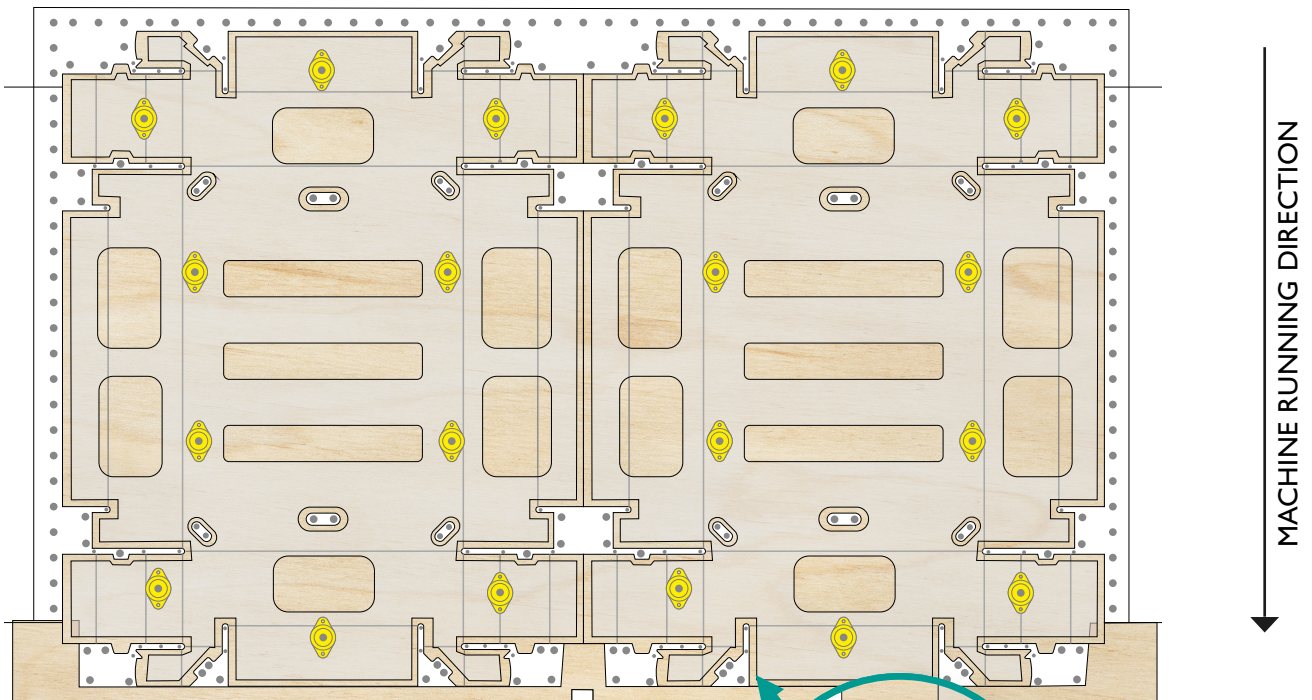

Maintain at least 5 mm (0.2") distance between the edge of the stripping plate and the presser plate.

